

Tunnel Light LED

Power Supply Efficiency: >88%
Power Factor: >0.95
Ambient Temperature: -40~55 °C
Life: 50000 hours

Materials: High purity aluminum reflector, housing and heat sink; 5mm high strength tempered glass cover; high power LED light source; high efficiency LED driver.

Application: Tunnels, underpasses, railways, underground parking lots and other places where lighting is needed.

Factories, gyms, docks, billboards, buildings, lawns, garden designs and other places where flood light and decoration lighting are needed.



ELIOT



T70S

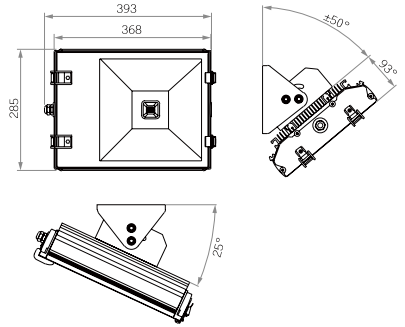

T140D

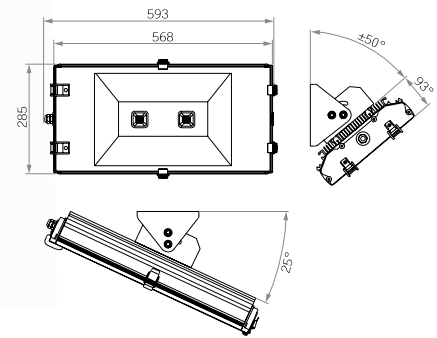

G70S

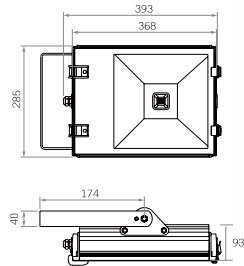

G140D

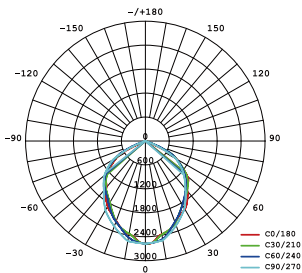
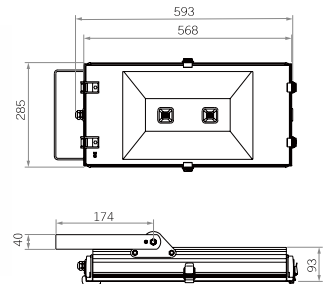

T70S

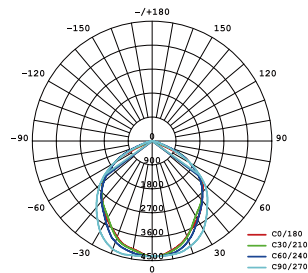

T140D

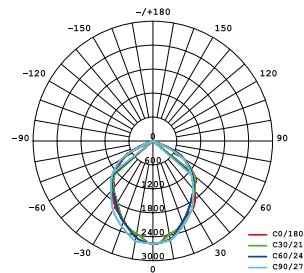

G70S

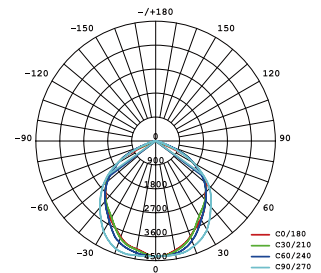

G140D

Code	Model	LED Power	Input Voltage	Lm/W	Ra	K	IP	Kg
io-102001	T70S	10~70	AC85~265	80~140	>70	2700~10000	IP65	8
io-102002	T140D	80-140	AC85~265	80~140	>70	2700~10000	IP65	11.4
io-102003	G70S	10~70	AC85~265	80~140	>70	2700~10000	IP65	7.8
io-102004	G140D	80-140	AC85~265	80~140	>70	2700~10000	IP65	11.2